

| | | |
|---------------------|---|---|
| KARTA - CARD | PRODUKT - PRODUCT | CMF-CFF |
| Z10/0 |  | KORPUSY DO ZAWORÓW NABOJOWYCH TYPU: VUBA-VSC-VRD LINE FITTINGS FOR VUBA-VSC-VRD CARTRIDGE SERIES |

ZASTOSOWANIE

Są to specjalne korpusy zaworów VUBA-VSC-VRD, w których umieszczane są cartridge, co znacznie zmniejsza koszty (specjalne otwory).

DOSTĘPNE WARIANTY:

Typy: męski/żeński lub żeński/żeński.

INSTALACJA

Umieścić cartridge w korpusie sprawdzając prawidłowość kierunku.

OPCJE

Czarne ocynkowanie - Specjalne wymiary - Dowolne znakowanie.

CHARAKTERYSTYKA

Stal ocynkowana - Gwint zewnętrzny przystosowany do podkładki.

APPLICATION

They are special line bodies inside which VUBA - VSC - VRD cartridges can be fitted, thus avoiding expensive solutions (special cavities).

OPTIONS AVAILABLE:

male / female or female / female types.

INSTALLATION

Fit the cartridges into their line bodies, checking the correct direction.

OPTIONAL

Black zinc-plating - Special dimensions - Custom marking.

FEATURES

Zinc-plated steel - Male end is arranged for washer centering.

| PARAMETRY - HYDRAULIC FEATURES | | | | | |
|-------------------------------------|-----|-----|-----|-----|-----|
| Wymiary Dimension | 01 | 02 | 03 | 04 | 05 |
| Ciśnienie max Max Pressure (bar) | 350 | 350 | 350 | 300 | 250 |

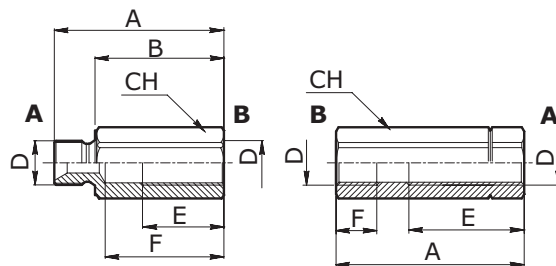

WYMIARY ZEWNĘTRZNE ORAZ WAGI - EXTERNAL DIMENSIONS AND WEIGHTS

| Typ Type | Wymiary Dimension | A | B | D gas | D sae | E | F | CH | Waga Weight (kg) |
|-------------|----------------------|-----|----|-------|-----------|----|----|----|---------------------|
| CMFVUBA | 01 | 50 | 38 | 1/4 | - | 23 | 31 | 19 | 0.070 |
| | 02 | 60 | 48 | 3/8 | 3/4-16 | 30 | 43 | 22 | 0.095 |
| | 03 | 63 | 49 | 1/2 | 7/8-14 | 33 | 45 | 27 | 0.147 |
| | 04 | 75 | 59 | 3/4 | 1 1/16-12 | 36 | 50 | 32 | 0.225 |
| | 05 | 88 | 70 | 1 | 1 5/16-12 | 46 | 60 | 41 | 0.425 |
| CFFVUBA | 01 | 50 | - | 1/4 | - | 20 | 12 | 19 | 0.070 |
| | 02 | 58 | - | 3/8 | 3/4-16 | 27 | 14 | 22 | 0.098 |
| | 03 | 60 | - | 1/2 | 7/8-14 | 33 | 19 | 27 | 0.145 |
| | 04 | 76 | - | 3/4 | 1 1/16-12 | 36 | 19 | 32 | 0.222 |
| | 05 | 85 | - | 1 | 1 5/16-12 | 46 | 18 | 41 | 0.435 |
| CMFVRD | 01 | 76 | 66 | 1/4 | - | 41 | 61 | 19 | - |
| | 02 | 82 | 70 | 3/8 | 3/4-16 | 41 | 63 | 22 | 0.110 |
| | 03 | 100 | 86 | 1/2 | 7/8-14 | 45 | 79 | 27 | 0.165 |
| | 04 | 112 | 96 | 3/4 | 1 1/16-12 | 55 | 86 | 32 | 0.250 |
| CFFVRD | 01 | 66 | - | 1/4 | - | 34 | 12 | 19 | 0.080 |
| | 02 | 70 | - | 3/8 | 3/4-16 | 37 | 14 | 22 | 0.110 |
| | 03 | 80 | - | 1/2 | 7/8-14 | 41 | 16 | 27 | 0.165 |
| | 04 | 100 | - | 3/4 | 1 1/16-12 | 54 | 19 | 32 | 0.250 |
| CMFVSC | 01 | 62 | 50 | 1/4 | - | 42 | 45 | 19 | 0.070 |
| | 02 | 82 | 70 | 3/8 | 3/4-16 | 41 | 63 | 22 | 0.095 |
| | 03 | 100 | 86 | 1/2 | 7/8-14 | 45 | 79 | 27 | 0.147 |
| CFFVSC | 01* | 50 | - | 1/4 | - | 21 | 12 | 19 | 0.080 |
| | 02 | 70 | - | 3/8 | 3/4-16 | 37 | 14 | 22 | 0.110 |
| | 03 | 80 | - | 1/2 | 7/8-14 | 50 | 16 | 27 | 0.165 |

* = Zawór umieszcza się w kierunku przeciwnym - Valve to be inserted in the reverse direction

KOD ZAMÓWIENIA - ORDERING CODE

| | | | | |
|----------|---------------------------------------|------------------------------------|---------------------|---------------------------|
| C | MF | VUBA | 02 | GAS |
| | Typ - Type | Cartridge zaworu - Cartridge valve | Wymiary - Dimension | Typ przyłącza - Port type |
| | MF Męski - Żeński Male - Female | VUBA | Typ-Type GAS SAE | GAS |
| | FF Żeński - Żeński Female - Female | VSC | 01 1/4 - | S SAE |
| | | VRD | 02 3/8 3/4-16 | |
| | | | 03 1/2 7/8-14 | |
| | | | 04 3/4 1 1/16-12 | |
| | | | 05 1 1 5/16-12 | |

PRZYKŁAD KODU ZAMÓWIENIA - ORDERING CODE EXAMPLE

| | |
|--------------------|---|
| C MF VUBA 2 | C - Typ Męski - Żeński - Zawór VUBA - Wymiary 02 - Gwint 3/8 GAS / C - Male-female Type - VUBA Valve - 02 Dimension - 3/8 GAS Port thread |
|--------------------|---|